

Floor Plans, General Notes:

- Unless labelled as "existing", assume features are to be newly constructed. (Refer to foundation and roof plans for the general boundaries of what is existing and what is to be newly constructed.)

Exterior Walls	Interior Walls
4" walls are dimensioned at 7.5" thick:	4" walls are dimensioned at 4.5" thick:
1/2" sheetrock	1/2" sheetrock
3 1/2" stud	3 1/2" stud
1/2" sheathing	1/2" sheetrock
1 1/2" rigid foam	
3/4" furring strip	plumbing walls are dimensioned at 6.5" thick:
wood siding/brick veneer	1/2" sheetrock
	5 1/2" stud
	1/2" sheetrock
6" walls are dimensioned at 9.5" thick:	
1/2" sheetrock	
5 1/2" stud	
1/2" sheathing	
1 1/2" rigid foam	
furring strip	
3/4" wood siding/brick veneer	
8" walls are dimensioned at 11.5" thick:	
1/2" sheetrock	
1/2" sheathing	
1 1/2" rigid foam	
furring strip	
3/4" wood siding/brick veneer	

Width of bridge section to be adjusted according to actual location of north wall, with side yard setback.

Window and lean-to shed to be centered on garage addition

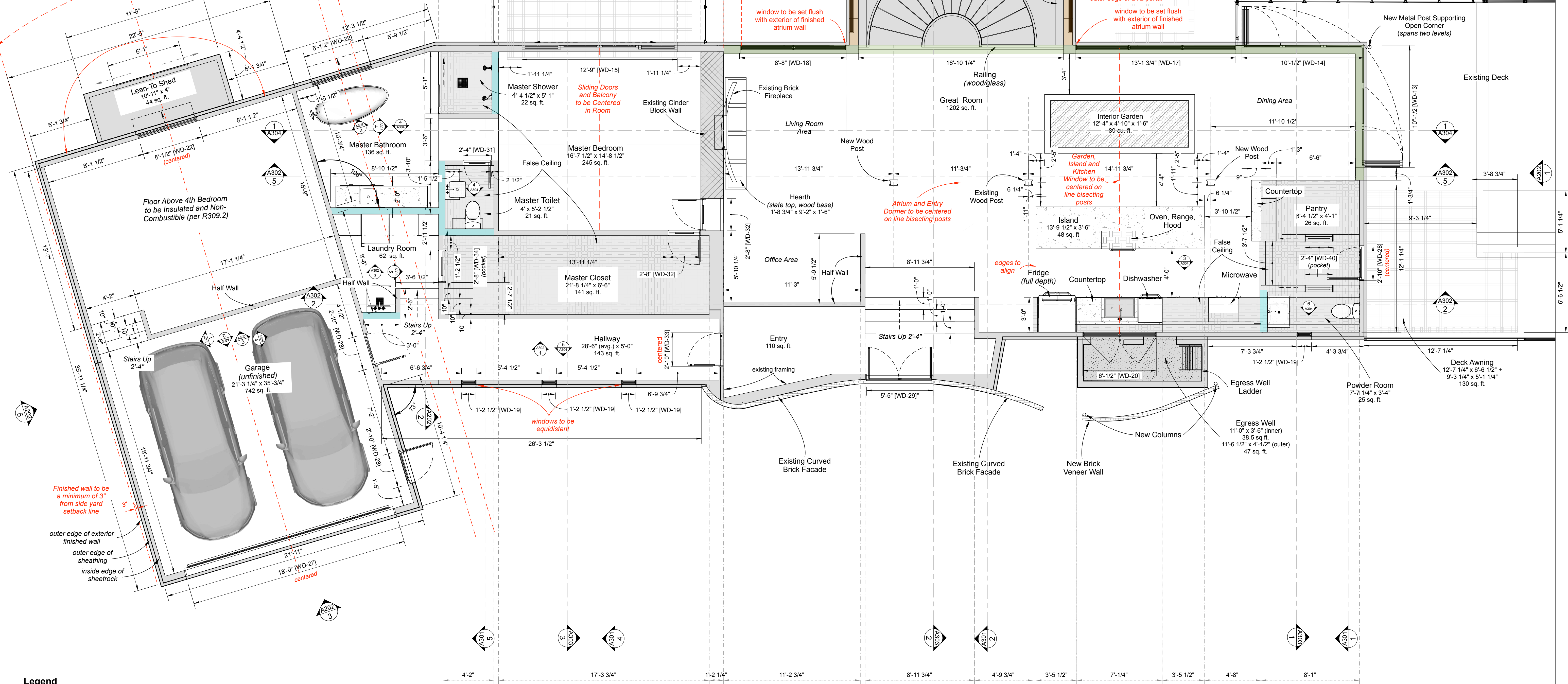

Legend

Section, shown on corresponding page.

[WD--] Window or Door labels are attached to window/door width. Note that width indicates the rough opening. See schedules on page A601.

Upper Level Floorplan **A102**
 *drawing scale 1/4" = 1'-0"



Design By:
Riedel-Fall Designs
 200 Union St. S.E.
 Minneapolis, MN 55455
 Tel: 612-275-9878

Design for:
Dr. Marc Riedel & Ms. Emery Fall
 5995 Ridge Rd.
 Shorewood, MN 55331
 Tel: 612-275-9878

Date	Revision	By
01/17/17	Initial Drawings	MDR, EKF
11/29/17	Atrium, Entry	MDR, EKF
5/7/18	Skylights, Foundations	MDR, EKF
7/3/18	Brick Entry	MDR, EKF
1/14/19	Permit Set/Drawings	MDR, EKF
3/21/19	Initial Construction Set	MDR, EKF
4/3/19	Revised Construction Set	MDR, EKF
4/28/19	Final Construction Set	MDR, EKF

DATE SUBMITTED
 04.28.19

DRAWN BY
 MDR, EKF

**A102 Upper Level
 Floorplan**

A102